

Domekt R 900 V C6M

Maximal air flow, m ³ /h	992
Maximal air flow, l/s	276
Reference flow rate, m ³ /s	0,193
Reference pressure difference, Pa	50
SPI, W/(m ³ /h)	0,3
Thermal efficiency of heat recovery, %	81
Electric air heater capacity, kW / Δt, °C	2/8,4
Supply voltage, V	1~230
Maximal operating current HE, A	13,8
Electric power input of the fan drive at maximum flow rate, W	241
Electric power input of the fan drive at reference flow rate, W	111
Filters dimensions BxHxL, mm	540x260x46
Unit dimensions BxHxL, mm	637x950x1070
Maintenance space, mm	1070
Unit weight, kg	110

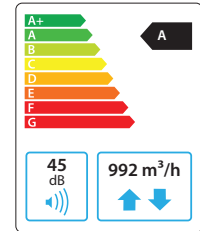

Acoustic data

A-weighted sound power level L_{WA} , dB(A) at reference flow rate

Supply inlet	56
Supply outlet	65
Exhaust inlet	56
Exhaust outlet	65
Casing	45

A-weighted sound pressure level L_{PA} , dB(A)

10 m² normally isolated room, distance from casing – 3 m.

Surroundings	35
--------------	----

Temperature efficiency

Outdoor temperature, °C	Winter					Summer		
	-23	-15	-10	-5	0	25	30	35
After heat exchanger, °C	13,6	15,1	16,0	16,9	17,9	22,6	235	24,4

indoor +22°C, 20 % RH

Shown as left (L1)

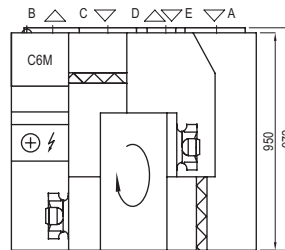

Shown as right (R1)

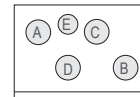

- A outdoor intake
- B supply air
- C extract indoor
- D exhaust air
- E additional extraction connection (by-pass – extraction without heat recovery)

Performance

Unit with standard equipment

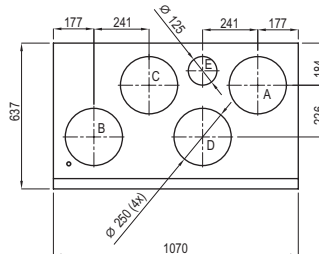
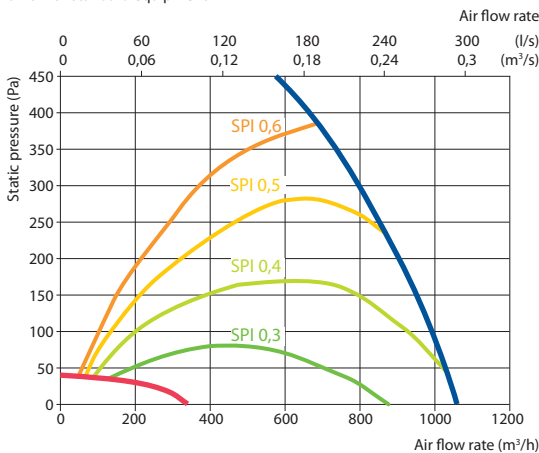

Accessories

Closing damper	AGUJ-M-250+LF230/CM230
Silencer	A/D AGS-250-50-900-M B/C AGS-250-50-1200-M
Water heater	DH-250
PPU	PPU-HW-3R-15-0,63-W2
2-way valve (water heater)	VVP47.10-0,63

Water cooler	DCW-0,9-6
2-way valve (water cooler)	VVP47.15-2,5
Outdoor grill	LD-250
Water heater-cooler	DHCW-315
DX heater-cooler	DCF-0,9-6
Heat pump unit	MOU-18HFN8+KA8140

C6.1

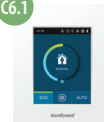

C6.2

